

4.3.2 DEVELOPMENT OF MUSEUM EXHIBIT ON NANOSCIENCE & NANOTECHNOLOGY

Barry Aprison, Museum of Science & Industry, Chicago

Chad Mirkin, NU-NSEC

Recognizing that one of the most effective ways to provide rich and stimulating learning experiences for people of all ages, interests, and backgrounds is through self-directed, voluntary exploration, the NU-NSEC entered into a partnership with the Museum of Science and Industry, Chicago (MSI) in 2001. This successful partnership creates an effective linkage between academia and an Informal Science Education (ISE) provider to create an educational program on nanoscale science and technology that is serving as a national model.

The overarching goal of the partnership is the development of a conceptual design plan for a unique exhibit called *Nanoverse* on nanoscience and nanotechnology. Approximately 20,000 square feet of space at MSI (currently part of Grainger Hall) has been allocated to this new initiative. Once completed, the exhibit has the potential to reach over 2 million people a year.

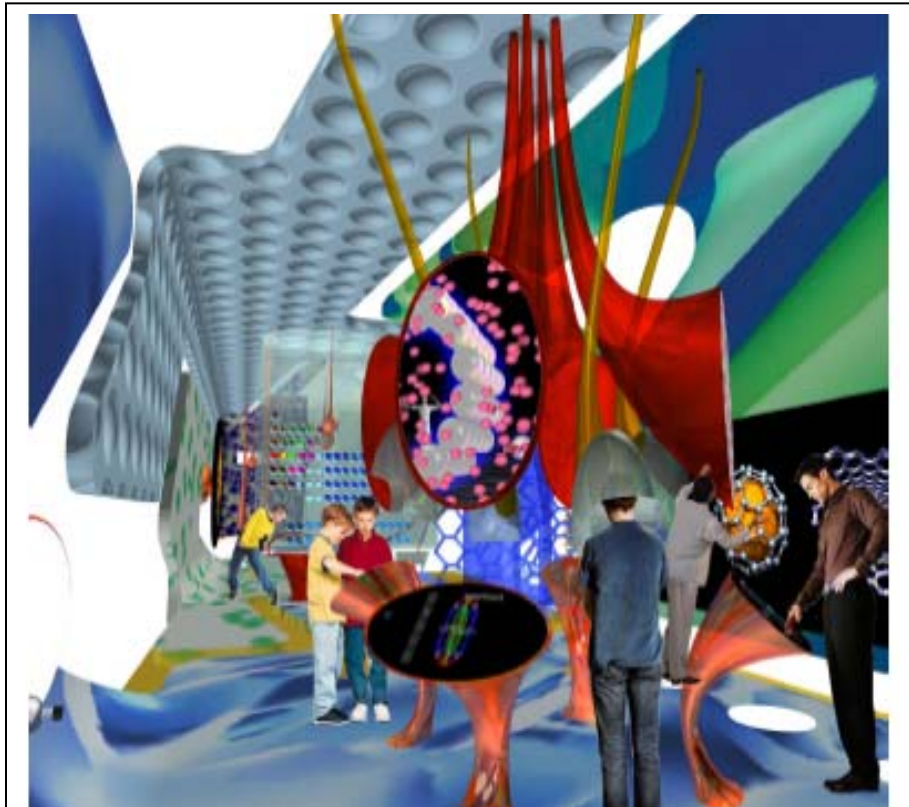

Graphic representation of one of the proposed interactives for the *Nanoverse* exhibit on nanoscience and nanotechnology